

TOTAL EXTENT (AS PER DOCUMENT) = 2469 Sq.M ✓
 ROAD AREA = 922 Sq.M ✓
 TOTAL No. OF PLOTS = 12 Nos. ✓
 CONVENIENT SHOP = 2 Nos. ✓

NOTE:

1. SPLAY - 1.5M x 1.5M
2. MEASUREMENTS ARE INDICATED EXCLUDING SPLAY DIMENSIONS
3. ROAD AREA WAS HANDED OVER TO THE LOCAL BODY VIDE GIFT DEED DOC.NO: 508 / 2019, DATED:11.01.2019 @ SRO, KUNDRATHUR

CONDITIONS:

(I). THE FOLLOWING CONDITIONS OF PWD VIDE CE, PWD, WRD, CHENNAI REGION, CHEPAUK, CHENNAI-5, LETTER NO.DB/T5(3)/ F- I & CULVERT-KUNDRATHUR / 2016/ 25.11.2016 ARE TO BE COMPLIED BY THE APPLICANT BEFORE SANCTION OF THE LAYOUT.

1. THE PROCESS OF EARTH FILLING AND COMPACTION SHOULD BE DONE FOR A DEPTH VARYING FROM 1.520 M TO 3.390 M DEPENDING UPON THE EXISTING FIELD LEVELS IN LAYERS OF NOT MORE THAN 0.30 METRE DEPTH TO ACHIEVE REQUIRED DEGREE OF COMPACTION AND THE EXISTING APPLICANT LAND SHOULD BE RAISED TO A LEVEL OF (+) 19.290M AND THE FILED UP TOP SURFACE SHOULD HAVE A GENTLE FALLING GRADIENT TOWARDS THE EAST/SOUTH DIRECTION.
2. THE ALL-ROUND PAVEMENT LEVEL WITHIN SITE SHOULD BE AT (+) 19.290M. THE APPLICANT SHOULD PROVIDE ALL-ROUND AND INTERIOR STORM WATER DRAINAGE NETWORK, SO THAT THE ULTIMATE DISPOSAL OF STORM WATER SHOULD BE DISCHARGED TO THE NEAREST NATURAL STORM WATER CHANNEL/DRAINS EXISTING ON THE EASTERN AND SOUTHERN SIDE OF THE APPLICANT'S LANDS. THE APPLICANT SHOULD MAKE DRAIN NETWORKS AT THEIR OWN COST AND THE SAME IS TO BE CONNECTED TO THE NATURAL STORM WATER DRAINAGE OR CHANNEL. ALSO THE APPLICANT SHOULD PROVIDE EMERGENCY PUMPING OPERATION FOR THE SEEPAGE WATER IF IT IS PROPOSED TO HAVE BASEMENT FLOOR.
3. THE APPLICANT SHOULD MAKE THEIR OWN ARRANGEMENTS TO COLLECT THE DEBRIS AND GARBAGE'S WITHIN THE PREMISES DURING DEMOLITION AND ALSO DURING THE CONSTRUCTION OF BUILDING AND HAS TO BE DISPOSED OFF AS PER THE NORMS PRESCRIBED BY THE TAMIL NADU POLLUTION CONTROL BOARD AND OTHER DEPARTMENTS CONCERNED AND SHOULD NOT BE DUMPED IN THE NEARBY CHANNEL, PUBLIC PLACES ETC.
4. THE APPLICANT SHOULD DO PROPER SOIL TEST, AND SUITABLE FOUNDATION SHOULD BE SELECTED DEPENDING UPON THE SOIL CONDITION AND THE STRUCTURAL DESIGNED SHOULD BE OBTAINED FROM THE APPROVED STRUCTURAL ENGINEER.
5. THE PWD/WRD, WILL NOT BE HELD RESPONSIBLE FOR THE STRUCTURAL STABILITY AND SOUNDNESS OF THE BUILDING PROPOSED BY THEM AND PWD/WRD SPECIFICALLY RECOMMEND ONLY FOR INUNDATION POINT OF VIEW.
6. THE APPLICANT SHOULD PROVIDE RAIN WATER HARVESTING ARRANGEMENTS IN THE SITE AT THEIR OWN COST.
7. THE APPLICANT SHOULD MAKE NECESSARY ARRANGEMENTS FOR THE SEWERAGE TREATMENT AND FOR ITS DISPOSAL AFTER OBTAINING NECESSARY PERMISSION FROM THE CHENNAI METROPOLITAN WATER SUPPLY AND SEWERAGE BOARD AND AS PER THEIR NORMS IN EXISTENCE AND AS AMENDED FROM TIME TO TIME AND SHOULD NOT BE LET INTO THE NEARBY CHANNEL OR STORM WATER DRAIN.
8. THE APPLICANT SHOULD PROVIDE A PUGCA COMPOUND WALL ALL-ROUND THE PROPOSED LAYOUT SITE AND A SETBACK DISTANCE OF ABOUT 3.0M SHOULD BE LEFT WHEREVER THE SITE ABUTTING THE CHANNEL.
9. THE APPLICANT SHOULD CLEARLY DEMARCATHE THE BOUNDARY OF THEIR LAND BEFORE THE COMMENCEMENT OF ANY DEVELOPMENTAL ACTIVITIES AND SHOULD NOT ENCROACH THE CHANNEL ABUTTING THE LAND.
10. THE APPLICANT SHOULD PROVIDE NECESSARY ARRANGEMENTS FOR FREE FLOW OF WATER THROUGH THE EXISTING CHANNEL TO THE DOWNSTREAM SIDE AREA WITHIN THE PROPOSED LAYOUT SITE. ALSO THE APPLICANT SHOULD DESILT THE CHANNEL PERIODICALLY AND REMOVE THE OBSTRUCTION THEN AND THERE WITHOUT ANY HINDRANCE FOR FREE FLOW OF WATER AT THEIR OWN COST WITHIN THE PROPOSED LAND AND CONDITION NO.5 STIPULATED FOR CULVERT PERMISSION FURNISHED BELOW.
11. THE APPLICANT SHOULD NOT CARRY OUT ANY OTHER CROSS MASONRY STRUCTURES ACROSS THE CHANNEL WITHOUT PRIOR PERMISSION FROM PWD.
12. THE PWD/WRD OFFICIALS SHOULD BE ALLOWED TO INSPECT THE SITE AT ANY TIME DURING EXECUTION AND AFTER COMPLETION OF PROJECT ALSO.

FAILING TO COMPLY WITH ANY OF THE ABOVE CONDITIONS, WRD RESERVES THE RIGHTS TO WITHDRAW THE REPORT ON CONSTRUCTION OF CULVERT ACROSS FIELD CHANNEL IN THE ABOVE SURVEY NUMBER & AS WELL AS ON INUNDATION POINT OF VIEW AND IN THAT EVENT, THE APPLICANT SHALL NOT BE ELIGIBLE FOR ANY COMPENSATION WHAT SO EVER.

(II). DR RULE NO: 29 (11)

THE COST OF LAYING IMPROVEMENTS TO THE SYSTEMS INRESPECT OF ROAD, WATER SUPPLY, SEWERAGE, DRAINAGE OR ELECTRIC POWER SUPPLY THAT MAY BE REQUIRED AS ASSESSED BY THE COMPETENT AUTHORITY, SHALL BE BORNE BY THE APPLICANT.

(III). LOCAL BODY SHOULD ENSURE COMPLIANCE OF ALL THE CONDITIONS STIPULATED BY PWD IN THEIR LETTER NO.DB/T5(3)/ F- I & CULVERT-KUNDRATHUR / 2016/ 25.11.2016. AND SHALL OBTAIN A LETTER FROM PWD CONFIRMING THE COMPLIANCE OF THE CONDITIONS BEFORE THE SANCTION AND RELEASE OF THE LAYOUT.

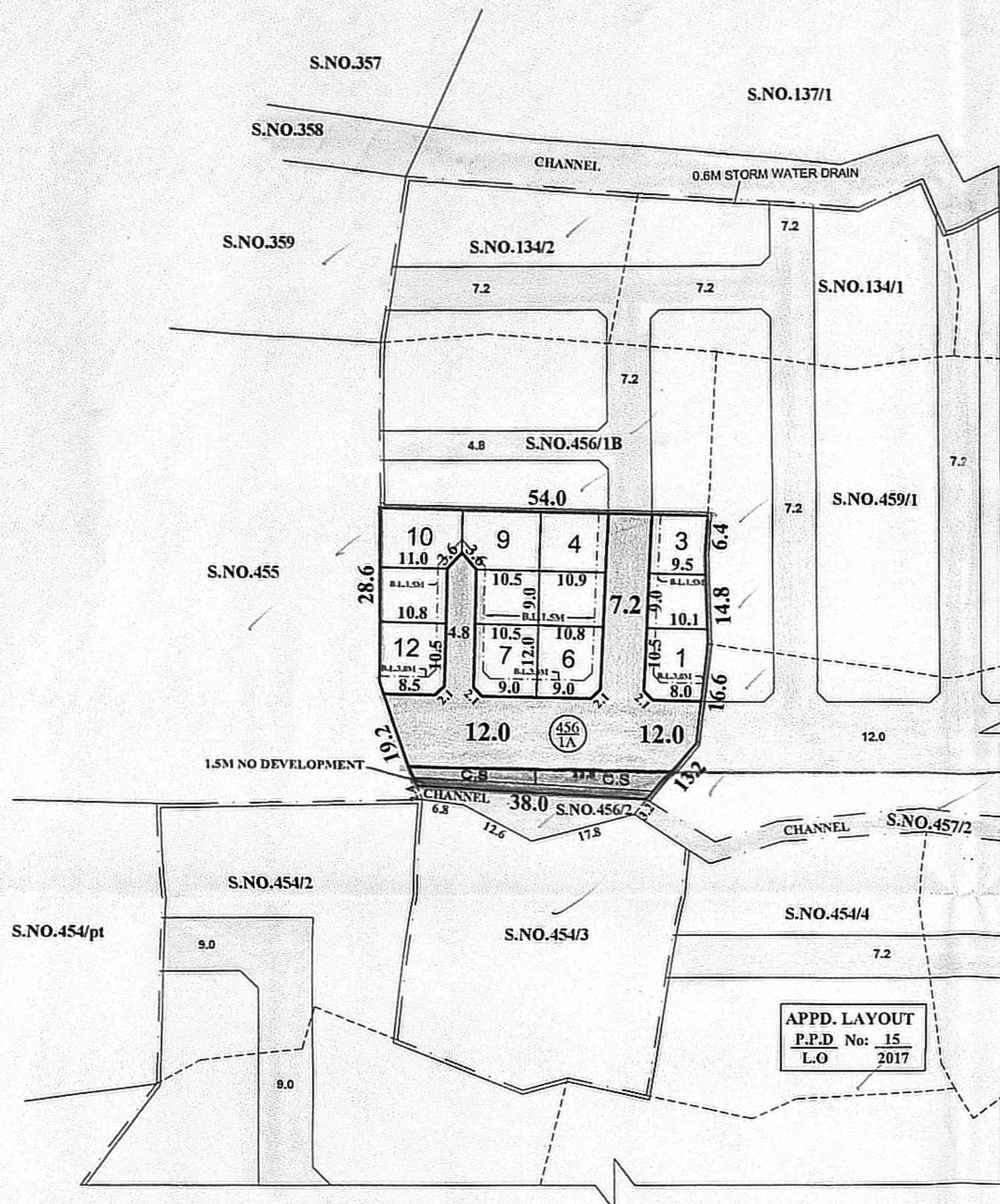

LEGEND:

- ▬ SITE BOUNDARY ✓
- ▬ ROADS GIFTED TO THE LOCAL BODY ✓
- ▬ EXISTING ROAD ✓
- ▬ CHANNEL ✓
- ▬ CONVENIENT SHOP ✓
- ▬ NO DEVELOPMENT AREA ✓

CONDITIONS:

THE LAYOUT APPROVED IS VALID SUBJECT TO OBTAINING SANCTION FROM THE LOCAL BODY CONCERNED.

P.P.D NO: 21
 L.O 2019

APPROVED

VIDE LETTER NO : L1/16492/2018 ✓
 DATE : /02/2019 ✓

PREPARED BY P.A-IV (S.M) 07/02/19
 CHECKED BY P.A.II (N.B.V) 08/02/2019
 A.P.(S.A)

KUNRATHUR TOWN PANCHAYAT
LAYOUT OF HOUSE SITES IN S.Nos:456/1A OF KUNRATHUR VILLAGE.

SCALE : 1:800 (ALL MEASUREMENTS ARE IN METRE.)

FOR MEMBER SECRETARY
 CHENNAI METROPOLITAN
 DEVELOPMENT AUTHORITY

